

NIAGARA

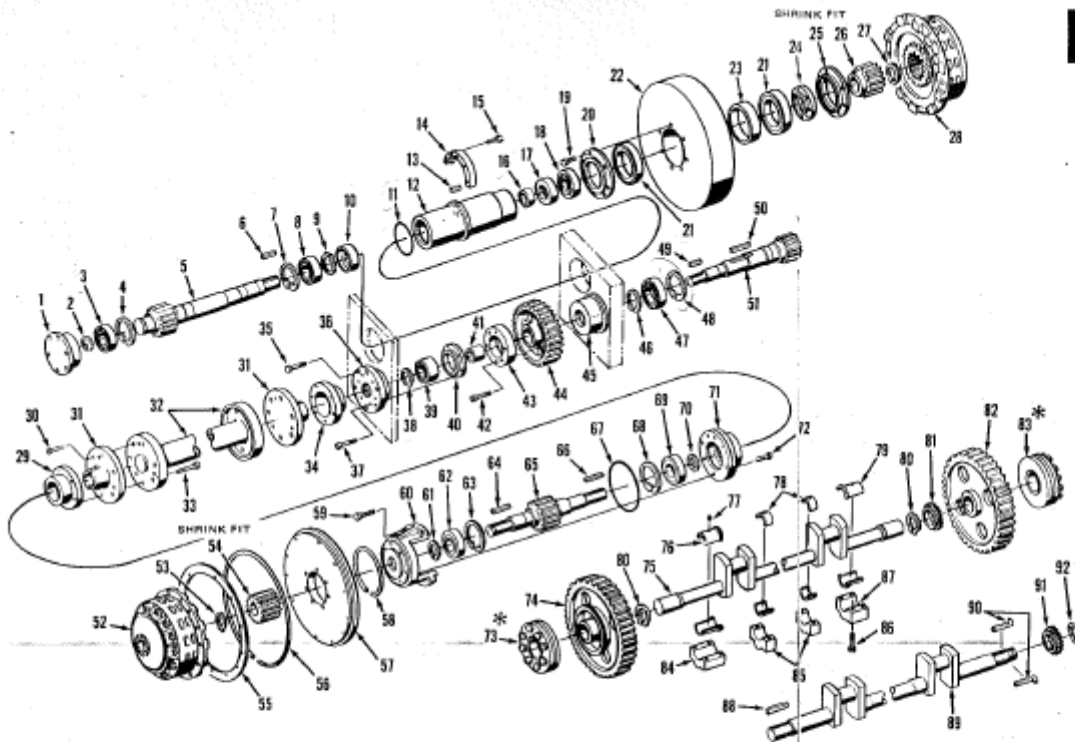

NOTE: Some models have provisions for lubricating flywheel bearings located on back-plate of flywheel guard or rear of housing under flywheel. On models without these provisions the flywheel must be removed and bearings repacked once each year. Use Chevron SR-1 No. 2 grease.

*Refer to Instruction Sheet on removal and installation.

- | | |
|----------------------------------|-----------------------------|
| 74. Main Gear | 56. Hose Ring (When Used) |
| 75. Crankshaft | 57. Brake Adapter Plate |
| 76. Bushing | 58. Hose Ring |
| 77. Dowel | 59. Bolt |
| 78. Bushing | 60. L.H. Bearing Housing |
| 79. Bushing | 61. Retaining Ring |
| 80. Retaining Ring | 62. Bearing |
| 81. Crankshaft Sprocket | 63. Retaining Ring |
| 82. Main Gear | 64. Key |
| 83. Shrink Disc | 65. L.H. Intermediate Shaft |
| 84. L.H. Bearing Cap | 66. Key |
| 85. Center Bearing Cap | 67. "O" Ring |
| 86. Bolt | 68. Retaining Ring |
| 87. R.H. Bearing Cap | 69. Bearing |
| 88. Tapered Key (When Used) | 70. Retaining Ring |
| 89. Keyed Crankshaft (When Used) | 71. L.H. Bearing Cartridge |
| 90. Tapered Keys (When Used) | 72. Capscrew |
| 91. Crankshaft Sprocket | 73. Shrink Disc |
| 92. Retaining Ring | |

NIAGARA STRAIGHT SIDE PRESSES

A-13-K-2-A DOUBLE GEARED TWIN END DRIVE (QUILL MOUNTED FLYWHEEL)

1. Driveshaft Bearing Cartridge
2. Retaining Ring
3. Bearing
4. Retaining Ring
5. Driveshaft
6. Key
7. Retaining Ring
8. Bearing
9. Retaining Ring
10. Labyrinth Ring (When Used)
11. "O" Ring
12. Quill
13. Key
14. Quill Clamp Collar
15. Bolt
16. Spacer (When Used)
17. Labyrinth Ring (When Used)
18. Bearing
19. Bolt
20. Flywheel Bearing Retainer
21. Flywheel Bearing
22. Flywheel
23. Flywheel Bearing Spacer
24. Quill Bearing Retainer
25. Flywheel Bearing Retainer
26. Clutch Hub
27. Retaining Ring
28. Clutch
29. Taper Lock Adapter (When Used)
30. Bolt

31. Coupling
32. Center Driveshaft
33. Capscrew (When Used)
34. Taper Lock Adapter (When Used)
35. Bolt
36. R.H. Intermediate Shaft Bearing Bracket
37. Capscrew
38. Retaining Ring
39. Bearing
40. R.H. Intermediate Shaft Bearing Retainer
41. Spacer
42. Capscrew
43. Taper Lock Adapter or Shrink Disc (When Used)
44. Intermediate Gear
45. R.H. Intermediate Shaft Bearing Cartridge
46. Retaining Ring
47. Bearing
48. Retaining Ring (When Used)
49. Key
50. Key (When Used)
51. R.H. Intermediate Shaft
52. Brake
53. Retaining Ring
54. Brake Hub
55. Brake Adapter Plate Ring (When Used)